

ZigBee* radio technology

The standard for radio (wireless) solutions, ideal for refurbishment, small new installations and increasing the number of control points, without damaging the walls.



INTERACTIVITY OF FUNCTIONS

ZigBee radio technology is an international low consumption radio communication standard.

This technology can be used in addition to the BUS system.

Operating at a frequency of 2.4 GHz, it can be used, via transmitters (wireless) and receivers, to control lighting, roller blinds and technical detectors. It can also control scenarios, and allows bi-directional communication between devices.

WIRING DIAGRAM

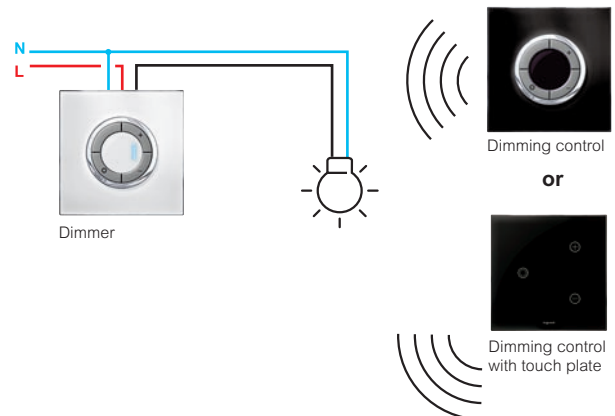

* ZigBee Certified product – Manufacturer Specific Profile

► LIGHTING CONTROL



RECEIVER DIMMER SWITCH
(See p. 12)
Indicates the light intensity via LEDs

► SCENARIO CONTROL



4 SCENARIO CONTROL
(See p. 12)
For lighting, roller blinds...

► ROLLER BLIND CONTROL



INDIVIDUAL RECEIVER ROLLER BLIND SWITCH
(See p. 12)
Controls any type of electric roller blind motor

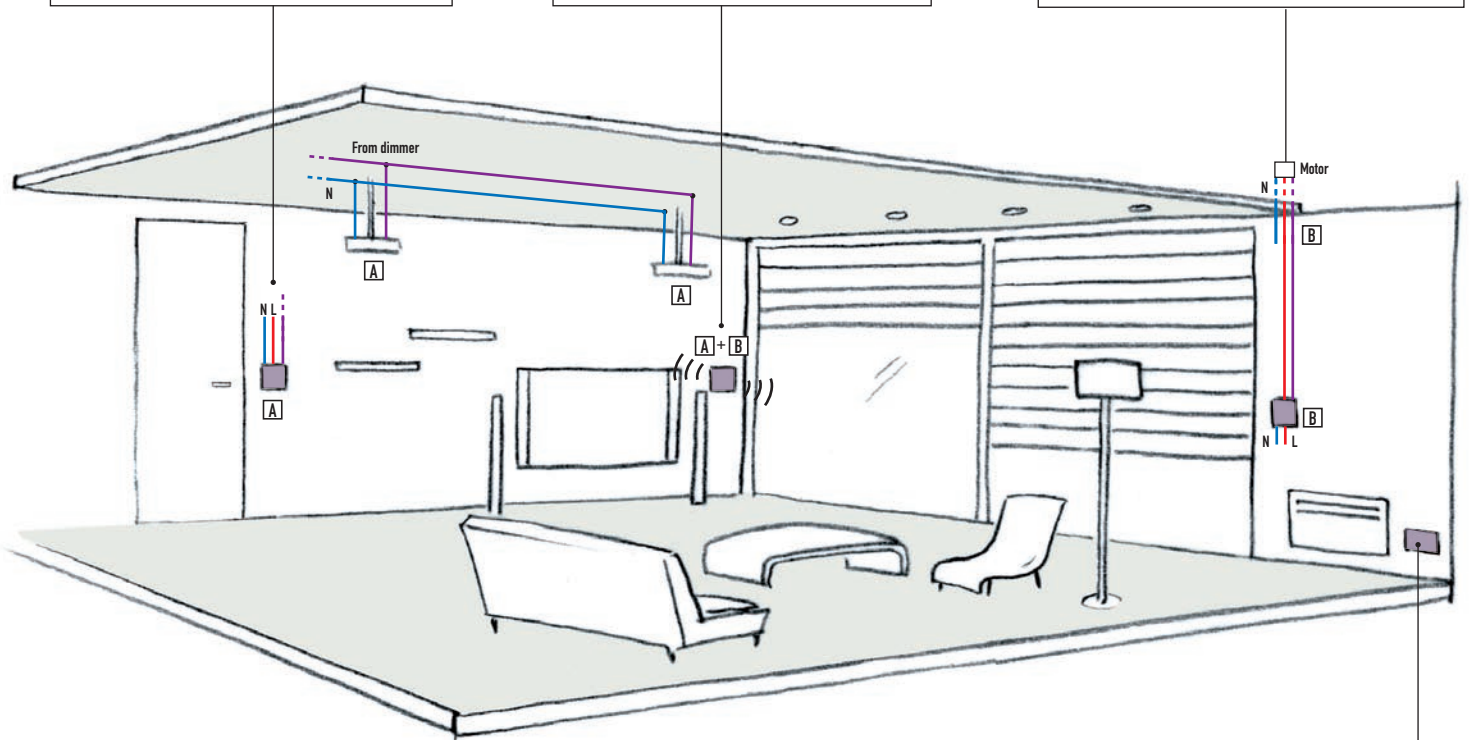

- A** Indicates lighting control
- B** Indicates roller blinds control

► TECHNICAL ALARM



TECHNICAL DETECTORS
(See p. 13)
Warning of water or gas leaks